

KVT control valve trim model PT-I

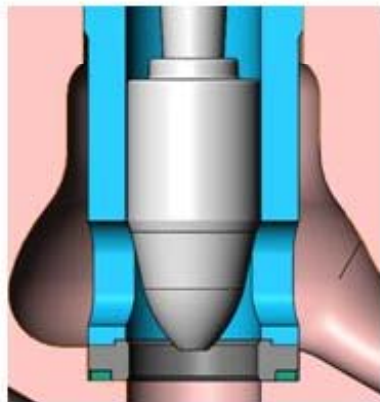
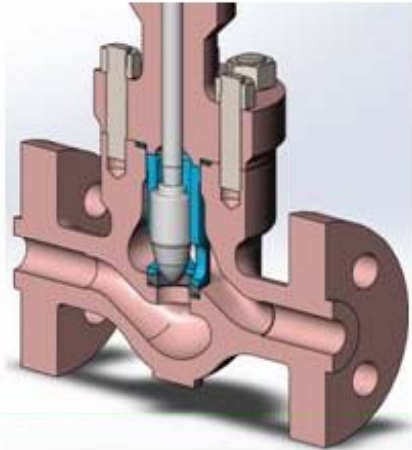

Trim Type	PT-I (Plug Throttling)
Valve Design	Straight, Angle, Y & Elbow down
Service Function	General Service
Valve Sizes, mm	DN15(1/2") ~ DN400(16")
Cv Range	1.4 ~ 1460
Flow Direction	Under, Over
WEB Seal Type	Quick Change
Leakage Class	IV or V, VI(Soft seat)
Flow Characteristic	Linear, Eq.%, Mod. Eq%
Cavitation Index Range	1.36
Balance of Trim	Unbalanced, Balanced
Rangeability	40:1
Typical Applications	Heater Drain, Reheat Spray, Cooling Water, Steam PRV
Features	<ul style="list-style-type: none"> ● Applicable for smaller size(6") and typical general service. ● Unbalanced trim is standard for this trim. ● Applicable for all kinds of fluid service ● Do not apply this trim under cavitation condition. ● Contoured plug flow control